

WHIRL-PAK®
Filtration Group



EXPERIENCE THE
GOLD STANDARD
ADVANTAGE

2024 - volume 65



WELCOME TO
WHIRL-PAK
SMARTER, SUSTAINABLE
SAMPLING SOLUTIONS

With Whirl-Pak you can expect simpler, safer and more productive solutions for all your sampling and testing needs. With 65 years of proven reliability, our high-quality products can help you ensure accurate results, from the field to the lab.



WHAT'S INSIDE...

The Gold Standard Advantage	3
Thio Bag	5
Stand-Up Bag	7
Filter Bag	9
Standard Bag	11
Write-On Bag	13
Sponge Bag	15
Black Bag	17
Additional Products	19
Pathway to Success	21
Index	23

EXPERIENCE THE GOLD STANDARD ADVANTAGE

Eliminate added costs, time and uncertainty with the most trusted, gold-standard closure bag utilized around the world. Whirl-Pak® bags are intentionally designed with one-of-a-kind features that ensure a leak-proof, sterilized, easy-to-use container for results you can trust – whirl, twirl or fold, it's not Whirl-Pak's premium quality if it doesn't have Whirl-Pak's new trademarked yellow tape.

- 1** POST-MANUFACTURING STERILIZATION
 - increased sample integrity
 - save time with a sterilized container for your samples
 - +1 Sterilization ensures sterilization with access to sterility documentation
- 2** PUNCTURE-PROOF CLOSURE TABS
 - tape extends beyond wire to eliminate sharp ends and provide a sturdy grip
 - wire tabs hold the top open for easy access to add to or remove sample
 - create a pour spout by pinching the wire for easy dispensing
 - worry-free, no-leak closure for sample integrity
- 3** OPENING PULL TABS
 - for easy opening
 - non-slip textured Tyvek®
 - our pull tabs are designed to keep hands away from the opening of the bag to retain the sterilized state of the inner bag, assuring samples are free of contamination.
 - when comparing to other closure bags, can you ensure the design allows for a aseptic handling?
- 4** CONVENIENT WRITE-ON STRIP
 - make labelling quick and EASY with pen or marker, can your current container say that?
 - clear sample identification for organization & traceability
- 5** BLENDED, VIRGIN POLYETHYLENE FILM
 - you can feel the difference!
 - exceptional clarity
 - superior strength
 - FDA approved for food contact
- 6** CONTINUOUS PERIMETER SEAL
 - maximum protection against leaks
 - as the ONLY closure bag on the market with welded seams, we are the most comparable to a rigid plastic container

2-PAK® **WHIRL-**

4

WHIRL-PAK®

6

3



1

3

Label your sample.

WHIRL-PAK

WHIR

5

WHIRL-PAK

WHIRL

YOUR WAY TO A
SECURE CLOSURE

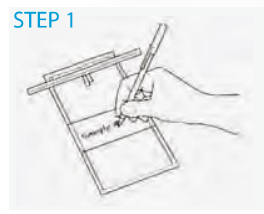

Label your sample.



To open, tear off the top along the perforation.

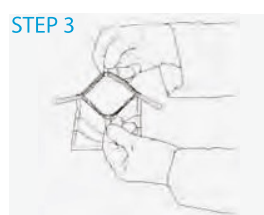

Use the Tyvek® pull tabs to open without contamination.



Place sample in the bag.

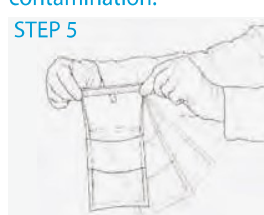

Hold bag by the tabs and whirl 3 to 4 times to make a seal.



Bring the two wire ends together and twist tie them.

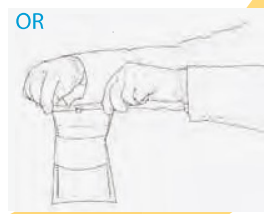

Fold down top of bag.

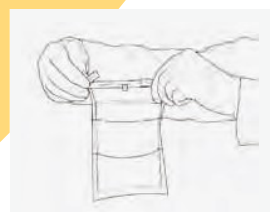

Bend wires in to seal.

4

THIO-BAG

EPA approved for more efficient microbiological water sampling and analysis.

Thio-Bags are specifically designed with a thiosulfate tablet already in the bag for sampling chlorinated water from municipalities, swimming pools, waste water, and other areas to test for fecal coliforms or other bacteria. Available in both a flat and stand-up bag.



STERILIZED FOR RESULTS YOU CAN TRUST.
Our bags go through post-manufacturing sterilization, known as +1 Sterilization.

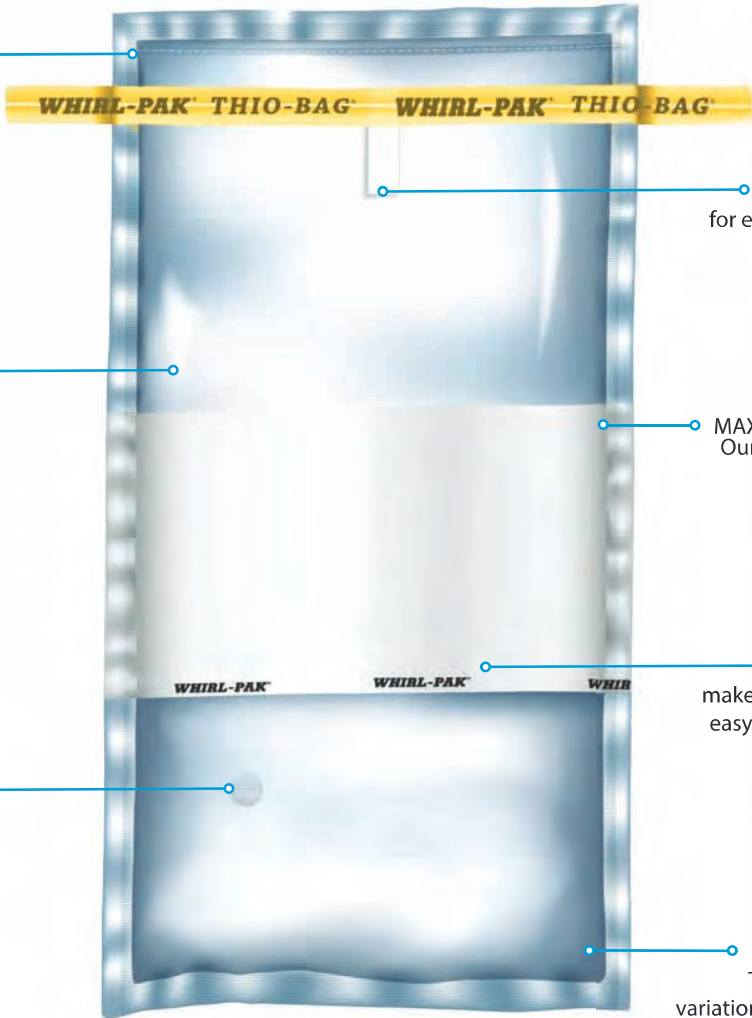

SUPERIOR STRENGTH AND CLARITY for quality you can trust, every time.

OPENING PULL TABS for easy, aseptic handling.

MAXIMUM PROTECTION AGAINST LEAKS. Our signature continuous perimeter seal ensures leak-proof results.

WRITE-ON STRIP makes labeling quick and easy with pen or marker!

THIOSULFATE TABLET to neutralize chlorine at the time of collection.

SELF STANDING BAGS
Thio bags come in two variations, with or without the gusseted bottom.

STYLE/SIZE

STAND-UP

118 mL
B01402

296 mL
B01403

503 mL
B01601

1,006 mL
B01603

FLAT

118 mL
B01040

296 mL
B01254

To learn more, or to view our entire product portfolio visit www.WHIRL-PAK.COM

STAND-UP BAG

Self-standing bag works like a bottle without the cost and storage constraints.

The Stand-Up bags have a gusseted bottom that unfolds when a sample is placed inside, allowing the bag to stand upright. By replacing bottles with Whirl-Pak Stand-Up bags you will save on product and disposal costs, have a guaranteed sterilized container, ensure for a safe and clean lab with shatterproof material, and use only a fraction of the storage and disposal space.



WHIRL-PAK[®]

STAND-UP BAG

WHI

STERILIZED FOR RESULTS YOU CAN TRUST. Our bags go through post-manufacturing sterilization, known as +1 Sterilization.

OPENING PULL TABS for easy, aseptic handling.

WRITE-ON STRIP makes labeling quick and easy with pen or marker!

SUPERIOR STRENGTH AND CLARITY for quality you can trust, every time

MAXIMUM PROTECTION AGAINST LEAKS. Our signature continuous perimeter seal ensures leak-proof results.

WHIRL-PAK[®]

WHIRL-PAK[®]

WHIRL-PAK[®]

SIZE

118 mL
B01364

532 mL
B01365

710 mL
B01401

1,065 mL
B01449

1,242 mL
B01450

2,041 mL
B01451

4,081 mL
B01542

To learn more, or to view our entire product portfolio visit www.WHIRL-PAK.COM

FILTER BAG

Easy transportation of samples from collection site to the lab and incubation.

Our Full Page Filter Bags are perfect for collecting, blending and pipetting. The filter layer inside the bag is sealed into the sides and bottom perimeter allowing liquids of a blended sample to transfer through the 330 micron filter, while solids remain separate and contained. Efficient and safe sampling.



WHIRL-PAK® FILTER BAG WHIRL-PAK®

STERILIZED FOR RESULTS YOU CAN TRUST. Our bags go through post-manufacturing sterilization, known as +1 Sterilization.

OPENING PULL TABS for easy, aseptic handling.

FULL PAGE FILTER for clean pipette sampling.

MAXIMUM PROTECTION AGAINST LEAKS. Our signature continuous perimeter seal ensures leak-proof results.

WRITE-ON STRIP makes labeling quick and easy with pen or marker!

SEALED FILTER LAYER Filter is sealed into both sides and bottom perimeter, allowing the sample to be placed in the bag on either side.

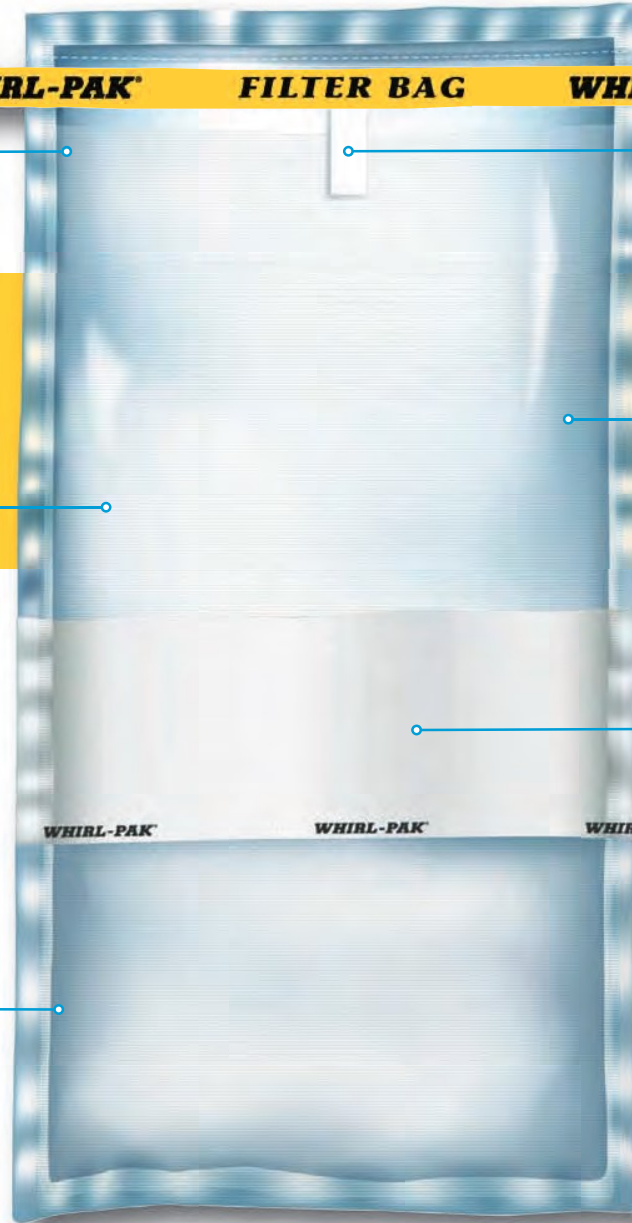

SIZES

207 mL B01385	710 mL B01348	*1,627 mL B01318	2,014 mL B01416	2,741 mL B01488	4,081 mL B01525	5,442 mL B01527
------------------	------------------	---------------------	--------------------	--------------------	--------------------	--------------------

*available with and without closure

To learn more, or to view our entire product portfolio visit www.WHIRL-PAK.COM

STANDARD BAG

First sterilized closure bag to market in 1959 and still a customer favorite.

Standard bags support your most basic collection and testing needs. Our standard bags, as will all of Whirl-Pak's sterilized sampling bags are R-Nase, D-Nase, Pyrogen and BPH free and comply with regulatory and industrial requirements of the FDA, USDA, HACCP and EPA.



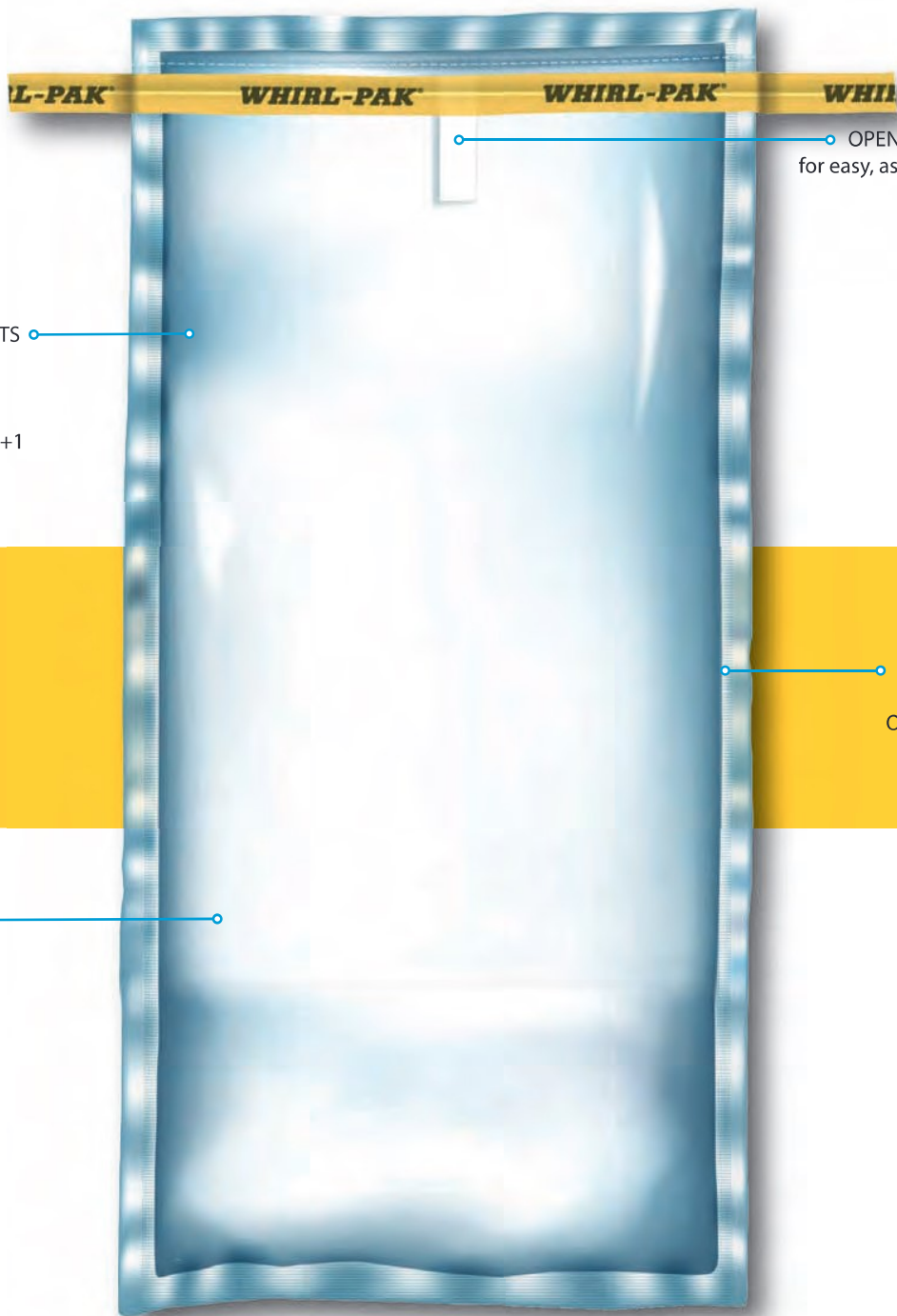

○ OPENING PULL TABS
for easy, aseptic handling.

STERILIZED FOR RESULTS
YOU CAN TRUST.
Our bags go through
post-manufacturing
sterilization, known as +1
Sterilization.

○ MAXIMUM PROTECTION
AGAINST LEAKS.
Our signature continuous
perimeter seal ensures
leak-proof results.

○ SUPERIOR STRENGTH
AND CLARITY
for quality you can
trust, every time

SIZES

59 mL B01009	118 mL B00679	207 mL B00992	384 mL B01018	532 mL B00736	710 mL B01020
710 mL B01063	798 mL B00990	1,065 mL B00994	1,242 mL B01027	1,627 mL B01532	2,041 mL B01323

To learn more, or to view our entire product portfolio visit www.WHIRL-PAK.COM

WRITE-ON BAG

Convenient write-on strip makes labeling quick and easy for clear sample identification.

Write-On bags offer a feature for operational organization and traceability. Pen or marker, Whirl-Pak's film will dry quickly for a streak free, and quick labeling of your samples.

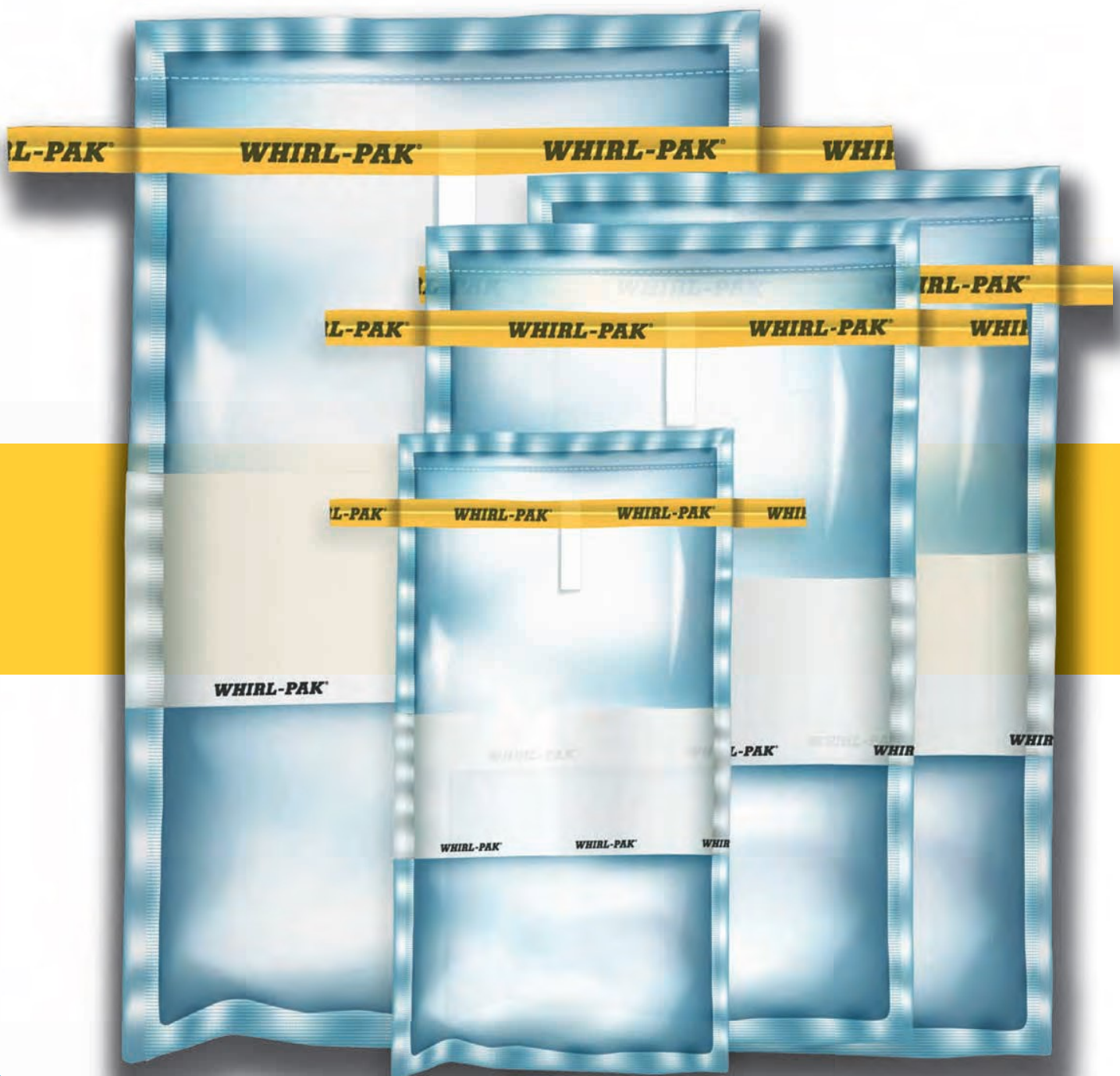

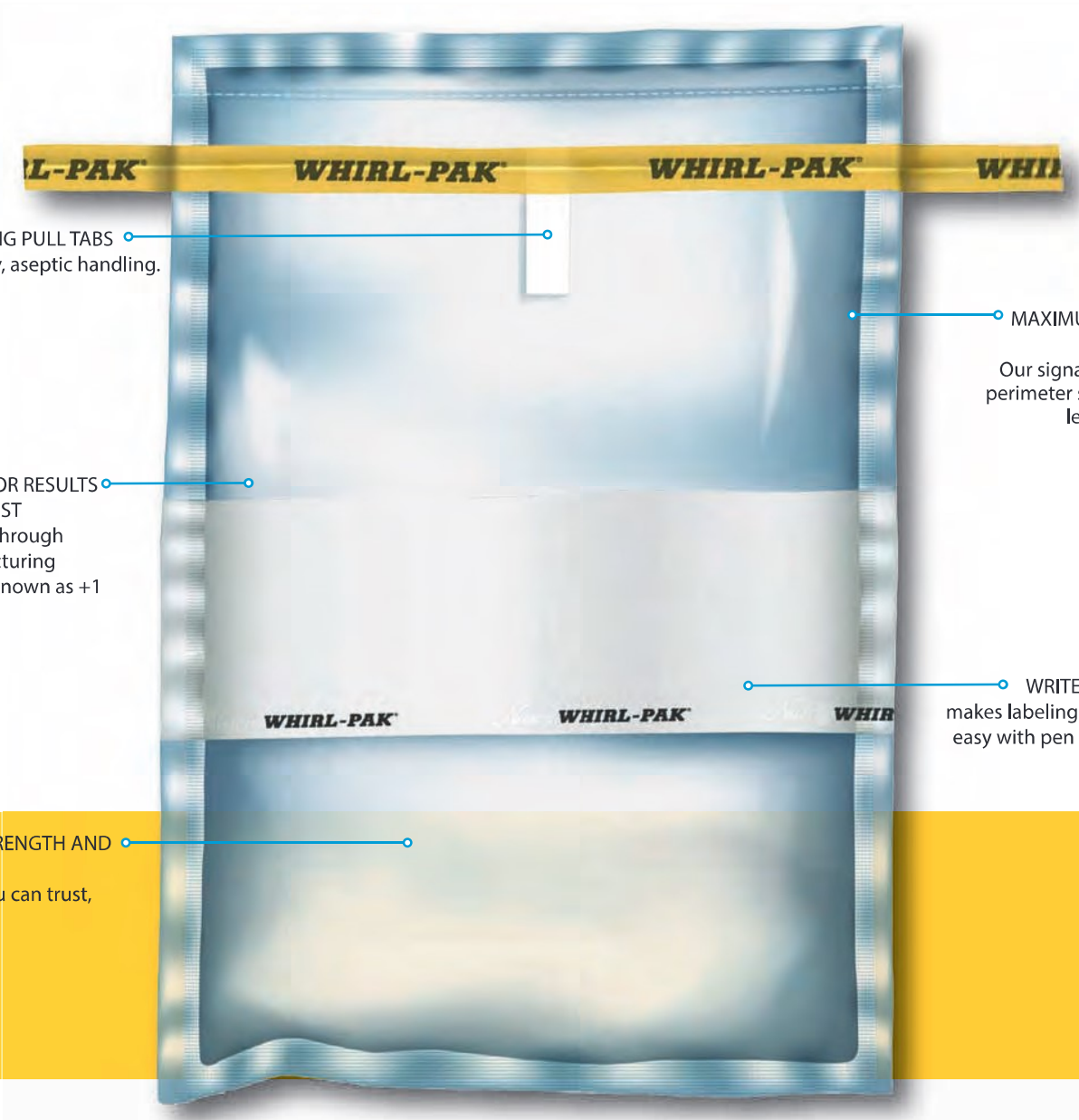

OPENING PULL TABS
for easy, aseptic handling.

STERILIZED FOR RESULTS
YOU CAN TRUST
Our bags go through
post-manufacturing
sterilization, known as +1
Sterilization.

SUPERIOR STRENGTH AND
CLARITY
for quality you can trust,
every time.

MAXIMUM PROTECTION
AGAINST LEAKS
Our signature continuous
perimeter seal ensures leak
leak-proof results.

WRITE-ON STRIP
makes labeling quick and
easy with pen or marker!

SIZES

59 mL B01064	118 mL B01339	118 mL B01062	207 mL B01489	384 mL B01490	532 mL B01065	532 mL B01341	710 mL B01297
710 mL B01196	798 mL B01491	1,627 mL B01195	2,041 mL B01515	2,721 mL B01445	3,638 mL B01446	5,441 mL B01447	

To learn more, or to view our entire product portfolio visit www.WHIRL-PAK.COM

POLYURETHANE SPONGE BAG

Easily cut through bio-films with our non-toxic, allergen free, polyurethane sponge.

The premium solution in environmental surface sampling, captured in the customer favorite's Write-on bag. Medical grade polyurethane sponges are super absorbent and resistant to tears, no more residue left behind when breaking through bio-films!

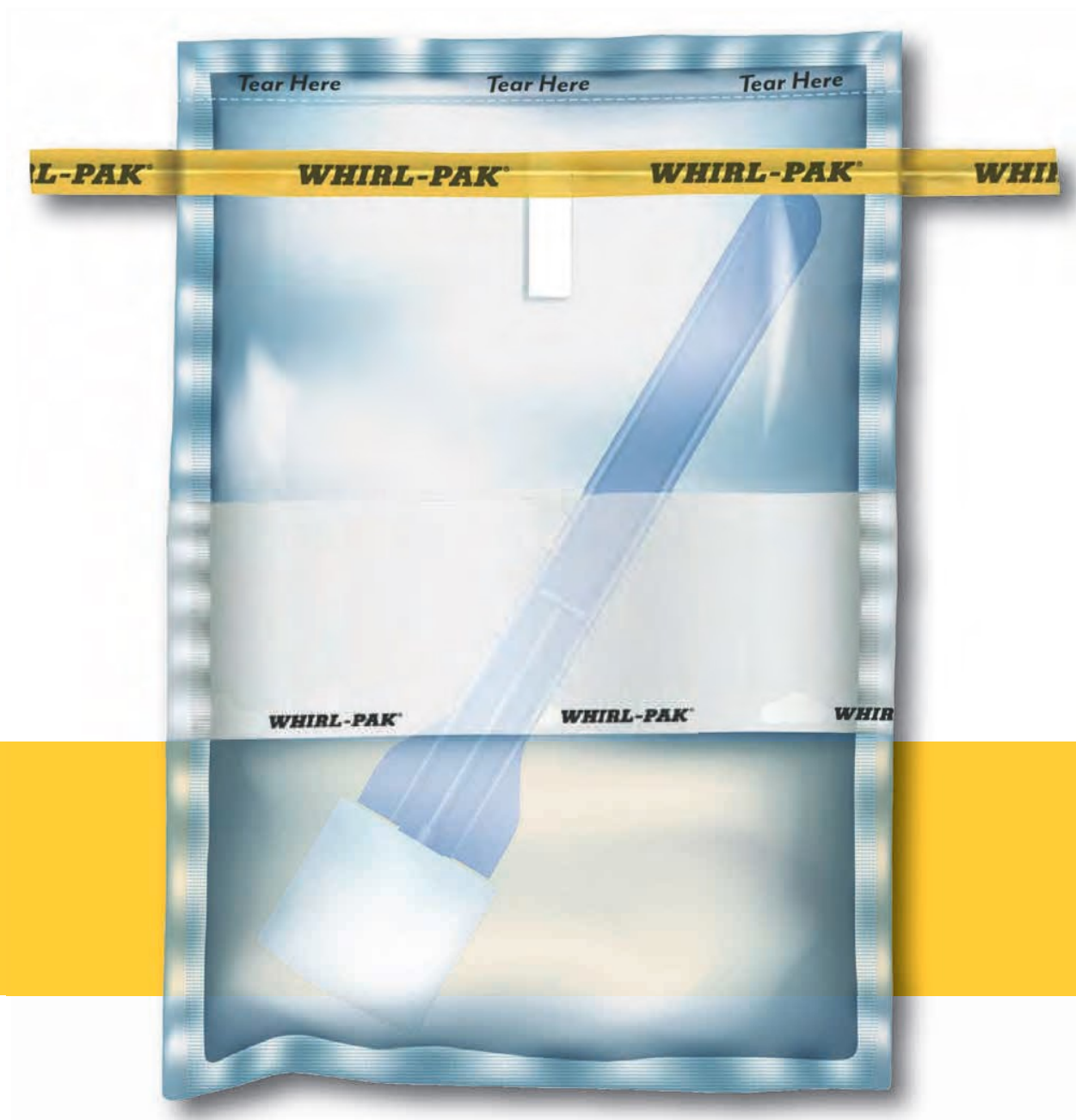

STERILIZED FOR RESULTS YOU CAN TRUST. Our bags go through post-manufacturing sterilization, known as +1 Sterilization.

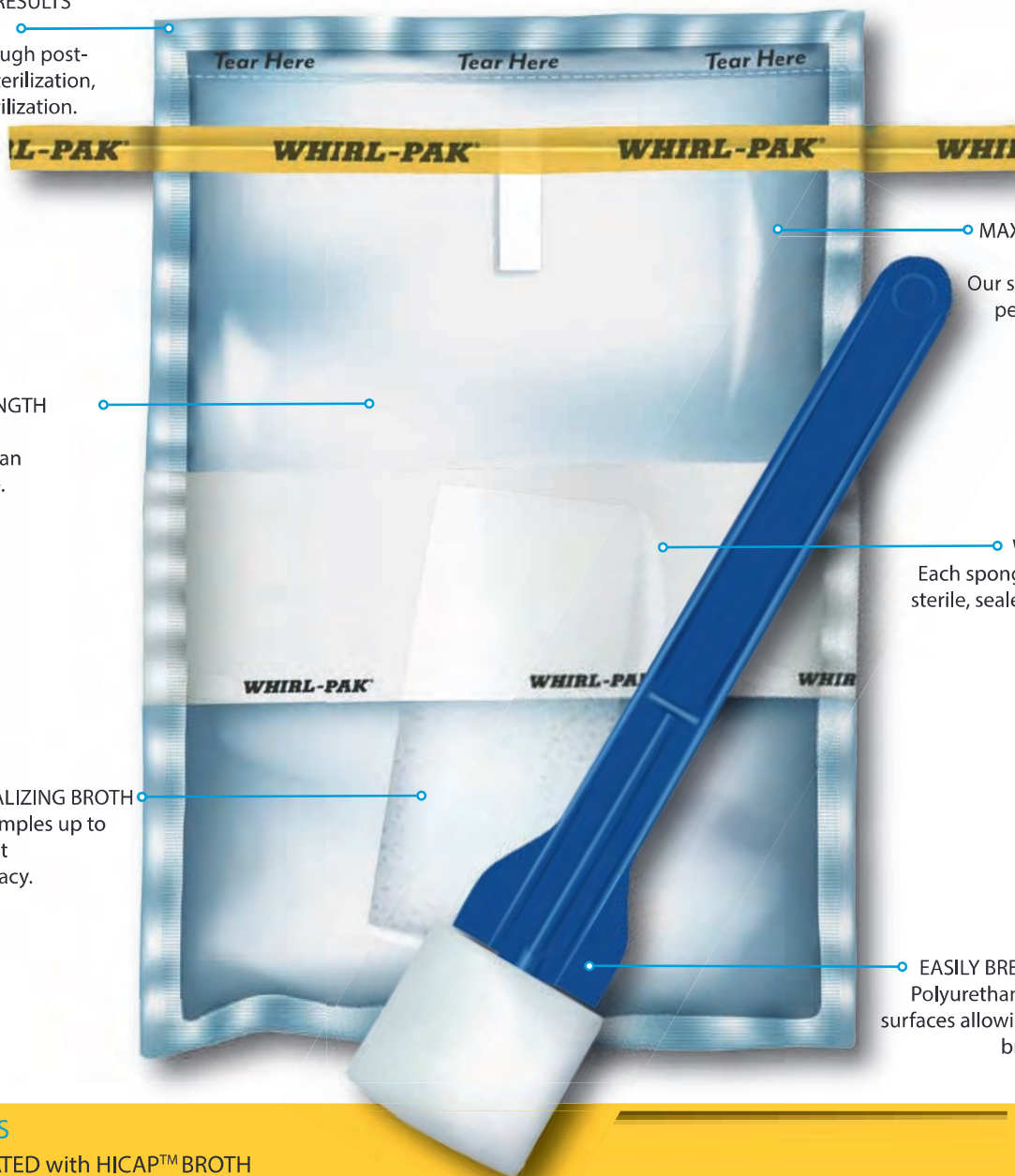

SUPERIOR STRENGTH AND CLARITY for quality you can trust, every time.

HICAP™ NEUTRALIZING BROTH protects your samples up to 72 hours without sacrificing accuracy.

MAXIMUM PROTECTION AGAINST LEAKS. Our signature continuous perimeter seal ensures leak-proof results.

WRITE-ON STRIP Each sponge is packed in a sterile, sealed write-on bag.

EASILY BREAK THROUGH BIOFILMS! Polyurethane sponge holds up to all surfaces allowing you to apply pressure breaking through biofilms for trusted results.

STYLES

HYDRATED with HICAP™ BROTH

PolyProbe™
B01592

PolySponge™
B01590/1591

DRY

PolyProbe™
B01613

BLACK BAG

Opaque film provides maximum protection for light-sensitive samples.

Whirl-Pak's Black Sterilized Bag provides the maximum protection when comparing all other opaque bags on the market. With built-in secure closure tabs, our black bags are ideal for the shipping and storage of all forms of sample material that are sensitive to light.

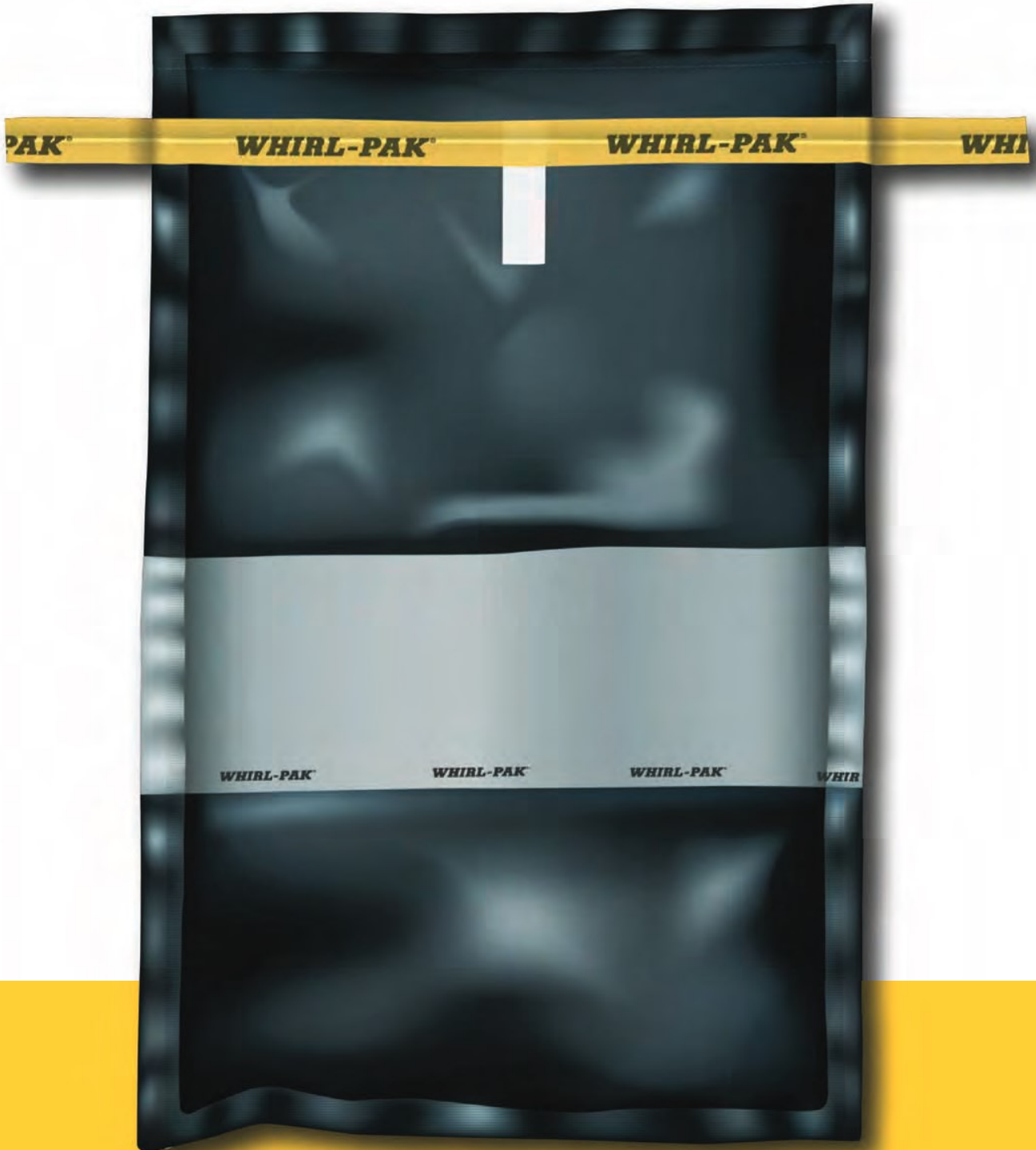

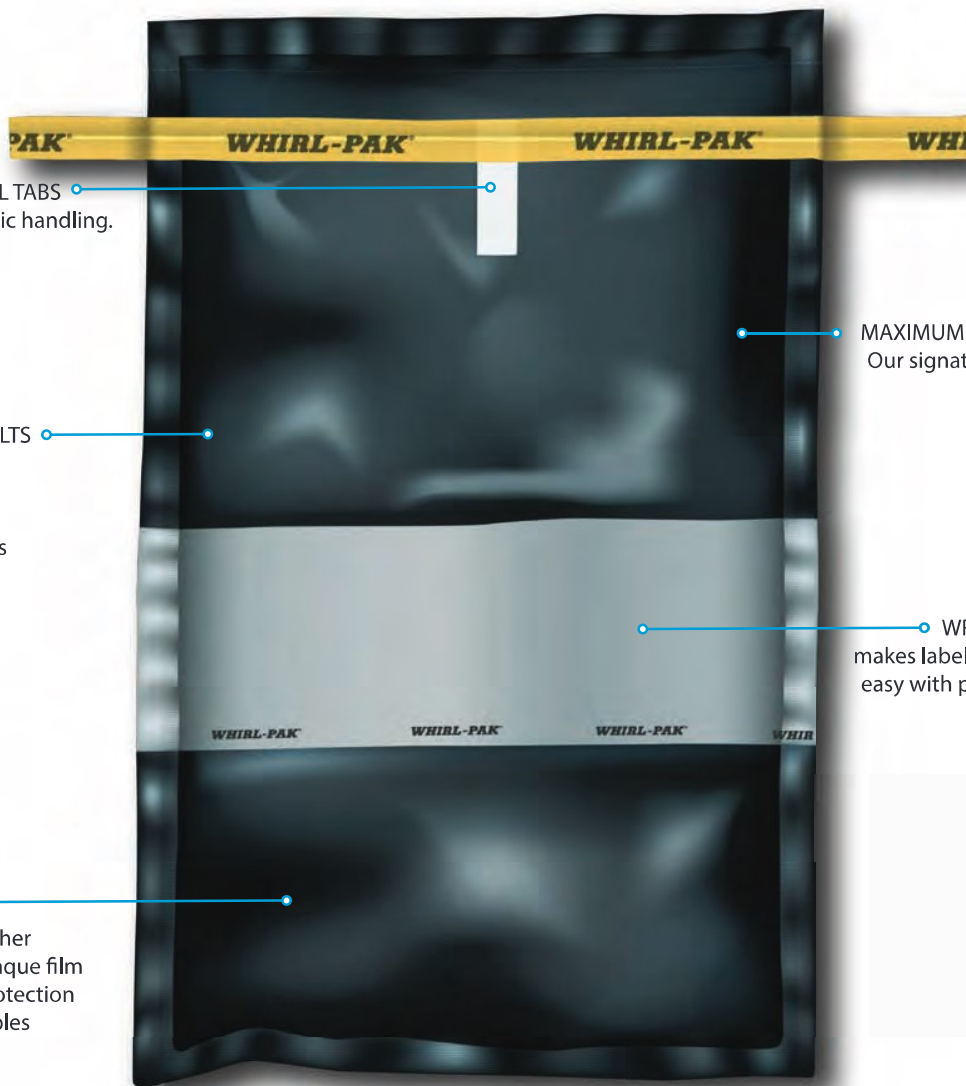

OPENING PULL TABS
for easy, aseptic handling.

STERILIZED FOR RESULTS
YOU CAN TRUST.
Our bags go through
post-manufacturing
sterilization, known as
+1 Sterilization.

OPAQUE FILM
When comparing to other
brands, Whirl-Pak's opaque film
provides maximum protection
for light sensitive samples

MAXIMUM PROTECTION AGAINST LEAKS.
Our signature continuous perimeter seal
ensures leak-proof results.

WRITE-ON STRIP
makes labeling quick and
easy with pen or marker!

SIZES

118 mL
B01472

532 mL
B01418

1,627 mL
B01558

To learn more, or to view our entire product portfolio visit www.WHIRL-PAK.COM



SLUDGE JUDGE SERIES

Take accurate readings of settleable solids of 5% or less in a variety of liquids.

Find the right fit for your needs in our Sludge Judge series. Whether you need the complete unit or a replacement part, we have the size you need for a cost-and time-efficient solution. The Sludge Judge and Sludge Judge II differ in diameter. SJ II offers an additional 1/4", and while the Sludge Judge Ultra is comparable in size to the Sludge Judge, it is differentiated by the polycarbonate treatment. Sludge Judge Ultra is treated with an ultraviolet stabilizer to help reduce deterioration from the sun's harmful rays. For Individual components visit www.whirl-pak.com

SJ UNIT

SJ ULTRA

SJ II UNIT

SWING SAMPLER

Intentionally designed for those collecting samples from a horizontal flowing stream.

Are you in need of an easy-to-use, time saving sample collection tool for horizontal flowing streams such as a sewer? Then the Swing Sampler is specially designed for you! The end of the sampler swings allowing collection from different angles, including 90° complete unit or a replacement part, we have the size you need for a cost-and time-efficient solution.



SIZE

6-12 FT.

8-24 FT.

SLUDGE NABBER

Make sample collection of liquids fast and easy.

The Sludge Nabber is an adjustable aluminum pole that extends from 1.22 to 1.99 m (4-6 1/2 ft.). Collection containers range from 250-1,000mL and can be placed in the base and held in place with an adjustable locking ring.



STORAGE RACKS

Easy transportation of samples from collection site to the lab and incubation.

Made of 10-and 12-gauge steel fused together for strong joints and straight lines. Racks are finished with an electro-statically applied powder coating for a durable and easy-to-clean finish which will stand up to many laboratory materials.



COMPARTMENTS

ONE

TWELVE

TWENTY

POURPOD™

Simple, seamless sample handling in the lab.

Our PourPod™ solution makes sample handling a breeze. Lab work is seamless with our sturdy sample-pouring accessory. Simply insert a full Whirl-Pak sample bag, and easily pour, measure and test the same way you would with bottles!



SMARTER SUSTAINABILITY

MEET YOUR NET ZERO GOALS

When compared to rigid plastic containers, studies have shown that Whirl-Pak® bags deliver a more cost-effective alternative to non-flexible containers. But that's not all; Whirl-Pak® bags also require fewer materials and less energy and water to produce, thus leaving a lower overall impact on the environment. With 65 years of proven reliability, our high-quality solutions are perfect for your sampling and testing needs.

REDUCE WASTE + ENVIRONMENTAL IMPACT



LESS MATERIAL

Whirl-Pak®'s Closure bags use 90% less material than rigid containers.



LESS WATER

The manufacturing process of Whirl-Pak® closure bags use 67% less water than rigid containers.



LESS EMISSIONS

Throughout its life-cycle, a Whirl-Pak® bag generates 91% less emissions, material than rigid containers.

REDUCE SPEND + HANDS-ON TIME

SPACE/STORAGE

Flexible storage containers, such as Whirl-Pak® bags, are more efficient in all space and storage scenarios.



TRANSPORTATION

Lower shipping costs and overall environmental impact when switching from bottles to Whirl-Pak® bags.



DISPOSAL

Save on disposal costs and service frequencies while increasing efficiency in the disposal process.



*A study was performed to identify the sustainability benefits when comparing one-time-use rigid containers to Whirl-Pak®'s Thio-Bags Rigid containers used in this comparison included PP, PET and HDPE Bottles.

PATHWAY TO SUCCESS

COST EFFECTIVE | IMPROVED USER EXPERIENCE | WASTE REDUCTION | DECREASED RISK

Make the switch!

Are you ready to make the switch from non-flexible containers to Whirl-Pak closure bags, but you're not quite sure where to start? At Whirl-Pak we can help you understand the important cost-reduction benefits for both your team and your facility in equipment, media, consumables, and more. Plus, we'll help you reduce hands-on time and reduce plastic waste - all while maintaining regulatory requirements.

FREQUENTLY ASKED QUESTIONS

Q: Is there a significant learning curve in the field or in the lab?

A: Multinational brands have reported a one-week learning curve.

Q: Are Whirl-Pak closure bags available through international distribution channels?

A: Whirl-Pak is available world-wide through best-in-class partners.

Q: Will this change require significant investments?

A: Multinational brands that have rolled out bottle-to-bag conversion have only captured savings.

Q: Do Whirl-Pak bags meet federal regulations?

A: Whirl-Pak bags are R-Nase, D-Nase, Pyrogen, BPH free and comply with FDA, USDA, HACCP, and EPA.

FROM IDEATION TO IMPLEMENTATION

We'll guide you in the following areas while offering continued implementation support and product expertise.

- Streamline raw material and finished product testing
- Product documentation and certifications
- Sustainability benefits - reduction of waste
- Reducing costs (equipment, media, consumables, hands-on time)
- Disposal time and costs savings
- Maintaining regulatory requirements
- Q&A product application session
- User training and solutions
- Liquid-locking closure training
- Our team is available to provide further insights on value-added product application opportunities for seamless implementation of Whirl-Pak products throughout your collection and analysis process

**MEET
YOUR
NET
ZERO
GOALS**

SUCCESSFUL ROLL-OUT

You recognize the cost, waste, and time-saving opportunities of making the switch from bottles to bags, and you have the data to prove it. But now what?

- 1** DEFINE: MAP OUT RAW MATERIAL AND FINISHED PRODUCT TESTING
 - Put together a list of bottles or other bag sizes currently used in your process. We'll provide a comparable list of products to streamline skus and suppliers utilized in your facility.
 - Where a bottle was once used - is there a stability concern on the scale or in the incubator? We can recommend solutions.
- 2** INFORM: NOTIFY PURCHASING AND SERVICES OF CHANGE
 - Provide a Whirl-Pak product list to your purchasing agent. Be sure no substitutes are made as the Whirl-Pak brand is necessary for risk aversion.
 - Notify disposal services of changes - frequency and volume will be reduced.
- 3** IDEATE AND EMPATHIZE: MEET WITH TEAMS TO CAPTURE THEIR CONCERNS
 - Meet with those collecting and analyzing samples to address questions or concerns.
 - Potential questions might include: Will this take more time? How does this impact other portions of my job? We've always done it this way, why change now?
 - Our team is available to provide resources and training, so your team understands the user-friendly benefits of Whirl-Pak bags and how this will help make their jobs safer and more efficient.
- 4** TEST: SET UP PRODUCT AND TESTING STATIONS
 - Make yourself available for one week to troubleshoot and challenges encountered in the cut-over stage.
 - After launch week, users are comfortable with the change and embrace the positive impacts beyond those mapped out for business efficiencies.

WHIRL-PAK PRODUCT INDEX

MFG. NO.	WIRESTYLE	VOLUME		SIZE		THICKNESS	BAGS/BOX
		FL OZ.	ML	IN.	CM		
WHIRL-PAK STANDARD BAGS: Plain, sterilized closure bags							
B01009	Round	2 Fl oz.	59 mL	3" W x 5" L	7.5 x 12.5 cm	2.25 mils	500
B00679	Round	4 Fl oz.	118 mL	3" W x 7¼" L	7.5 x 18.5 cm	2.25 mils	500
B00992	Round	7 Fl oz.	207 mL	3¾" W x 7" L	9.5 x 18 cm	3 mils	500
B01018	Round	13 Fl oz.	384 mL	5¼" W x 7½" L	13 x 19 cm	3 mils	500
B00736	Round	18 Fl oz.	532 mL	4½" W x 9" L	11.5 x 23 cm	2.5 mils	500
B01020	Round	24 Fl oz.	710 mL	6" W x 9" L	15 x 23 cm	3 mils	500
B01063	Round	24 Fl oz.	710 mL	6" W x 9" L	15 x 23 cm	4 mils	500
B00990	Round	27 Fl oz.	798 mL	5" W x 12" L	12.5x30.5cm	3 mils	500
B00994	Round	36 Fl oz.	1,065 mL	5" W x 15" L	12.5 x 38 cm	3 mils	500
B01027	Round	42 Fl oz.	1,242 mL	6" W x 15" L	15 x 38 cm	3 mils	500
B01532	Round	55 Fl oz.	1,627 mL	7½" W x 12" L	19 x 30 cm	3 mils	500
B01323	Round	69 Fl oz.	2,041 mL	7½" W x 15" L	19 x 38 cm	3 mils	500
WHIRL-PAK WRITE-ON BAGS: Sterilized closure bag with additional benefit of a white write-on strip							
B01064	Round	2 Fl oz.	59 mL	3" W x 5" L	7.5 x 12.5 cm	2.25 mils	500
B01339	Flat	4 Fl oz.	118 mL	3" W x 7¼" L	7.5 x 18.5 cm	2.25 mils	500
B01062	Round	4 Fl oz.	118 mL	3" W x 7¼" L	7.5 x 18.5 cm	2.25 mils	500
B01489	Round	7 Fl oz.	207 mL	3¾" W x 7" L	9.5 x 18 cm	3 mils	500
B01490	Round	13 Fl oz.	384 mL	5¼" W x 7½" L	13 x 19 cm	3 mils	500
B01065	Round	18 Fl oz.	532 mL	4½" W x 9" L	11.5 x 23 cm	2.5 mils	500
B01341	Flat	18 Fl oz.	532 mL	4½" W x 9" L	11.5 x 23 cm	2.5 mils	500
B01297	Round	24 Fl oz.	710 mL	6" W x 9" L	15 x 23 cm	3 mils	500
B01196	Round	24 Fl oz.	710 mL	6" W x 9" L	15 x 23 cm	4 mils	500
B01491	Round	27 Fl oz.	798 mL	5" W x 12" L	12.5x30.5cm	3 mils	500
B01195	Round	55 Fl oz.	1,627 mL	7½" W x 12" L	19 x 30 cm	4 mils	500
B01515	Round	69 Fl oz.	2,041 mL	7½" W x 15" L	19 x 38 cm	3 mils	500
B01445	1Flat,1Round	92 Fl oz.	2,721 mL	10" W x 15" L	25.4 x 38 cm	4 mils	250
B01446	1Flat,1Round	123 Fl oz.	3,638 mL	10" W x 20" L	25.4x50.8cm	4 mils	250
B01447	1Flat,1Round	184 Fl oz.	5,441 mL	15" W x 20" L	38 x 50.8 cm	4 mils	100
WHIRL-PAK STAND-UP (UNDOSED) BAGS: Self-standing sterilized closure bags with a white write-on strip							
B01364	Round	4 Fl oz.	118 mL	3" W x 7¼" L	7.5 x 18.5 cm	2.25 mils	500
B01365	Round	18 Fl oz.	532 mL	4½" W x 9" L	11.5 x 23 cm	3 mils	500
B01401	Round	24 Fl oz.	710 mL	6" W x 9" L	15 x 23 cm	3 mils	500
B01449	1Flat,1Round	36 Fl oz.	1,065 mL	5" W x 15" L	12.5 x 38 cm	4 mils	250
B01450	1Flat,1Round	42 Fl oz.	1,242 mL	6" W x 15" L	15 x 38 cm	4 mils	250
B01451	1Flat,1Round	69 Fl oz.	2,041 mL	7½" W x 15" L	19 x 38 cm	4 mils	250
B01542	1Flat,1Round	138 Fl oz.	4,081 mL	15½" W x 15" L	38 x 38 cm	4 mils	100
WHIRL-PAK STAND-UP THIO-BAGS (DOSED): Self-standing sterilized closure bags with a white write-on strip and a thiosulfate tablet included in the bag							
			* LIQUID FILL LINE				
B01402	Round	4 Fl oz.	100 mL	3" W x 7¼" L	7.5 x 18.5 cm	2.25 mils	100
B01403	Round	10 Fl oz.	300 mL	4½" W x 9" L	11.5 x 23 cm	3 mils	100
B01601	1Flat,1Round	17 Fl oz.	500 mL	6" W x 9" L	15 x 23 cm	3 mils	100
B01603	1Flat,1Round	34 Fl oz.	1,000 mL	6" W x 15" L	15 x 38 cm	4 mils	100
WHIRL-PAK THIO-BAGS: Sterilized closure bags with a white write-on strip and a thiosulfate tablet included in the bag							
			* LIQUID FILL LINE				
B01040	Round	4 Fl oz.	100 mL	3" W x 7¼" L	7.5 x 18.5 cm	2.25 mils	100
B01254	Round	10 Fl oz.	300 mL	4½" W x 9" L	11.5 x 23 cm	2.5 mils	100

WHIRL-PAK PRODUCT INDEX (continued)

MFG. NO.	WIRESTYLE	VOLUME		SIZE		THICKNESS	BAGSORUNITS/BOX
		FL OZ.	ML	IN.	CM		
WHIRL-PAK FULL-PAGE FILTER BAGS: Sterilized bags with a white write-on strip and a 330 micron filter layer							
B01385	Round	7 Fl oz.	207 mL	3¾" W x 7" L	9.5 x 18 cm	3 mils	250
B01348	Round	24 Fl oz.	710 mL	6" W x 9" L	15 x 23 cm	4 mils	250
B01318	Round	55 Fl oz.	1,627 mL	7½" W x 12" L	19 x 30 cm	4 mils	250
B01547	NOCLOSURE	55 Fl oz.	1,627 mL	7½" W x 12" L	19 x 30 cm	4 mils	250
B01416	Round	69 Fl oz.	2,041 mL	7½" W x 15" L	19 x 38 cm	4 mils	250
B01488	1Flat,1Round	92 Fl oz.	2,721 mL	10" W x 15" L	25.4 x 38 cm	4 mils	100
B01525	1Flat,1Round	138 Fl oz.	4,081 mL	15" W x 15" L	37.5x37.5cm	4 mils	100
B01527	1Flat,1Round	184 Fl oz.	5,442 mL	15" W x 20" L	37.5 x 50 cm	4 mils	100
WHIRL-PAK SPECIALTY FILTER BAGS							
B01239 ROUNDBOTTOM-	Round	52 Fl oz.	1,538 mL	7" W x 13" L	18.5 x 33 cm	4 mils	500
B01421	NOCLOSURE	55 Fl oz.	1,627 mL	7½" W x 12" L	19 x 30 cm	3 mils	1,000
B01474	NOCLOSURE	184 Fl oz.	5,442 mL	15" W x 20" L	37.5 x 50 cm	4 mils	250
WHIRL-PAK BLACK BAGS: Opaque, sterilized closure bag with a white write-on strip							
B01472	Round	4 Fl oz.	118 mL	3" W x 7¼" L	7.5 x 18.5 cm	2.5 mils	500
B01418	Round	18 Fl oz.	532 mL	4½" W x 9" L	11.5 x 23 cm	2.5 mils	500
B01558	Round	55 Fl oz.	1,627 mL	7½" W x 12" L	19 x 30 cm	2.5 mils	500
WHIRL-PAK SPECIALTY BAGS: Specific Market use, added features							
B01538 - USDA	Round	24 Fl oz.	710 mL	6" W x 9" L	15 x 23 cm	3 mils	500
B01363 - NOPA	Round	18 Fl oz.	532 mL	6" W x 12" L	15 x 30 cm	4 mils	500
B01324 CARCASS SAMPLING	Each Meat and Poultry Carcass Sampling Kit includes a Sponge, Template, Peptone and Whirl-Pak Bag						25
B01319 POULTRY BAG	NOCLOSURE	184 Fl oz.	3,638 mL	15" W x 20" L	37.5 x 50 cm	2 mils	250
B01350 BW/BLUESCOOP	Round	18 Fl oz.	532 mL	4.5" W x 9" L	11.5 x 23 cm	2.5 mils	50
B01350 W/WHITESCOOP	Round	18 Fl oz.	532 mL	4.5" W x 9" L	11.5 x 23 cm	2.5 mils	50
WHIRL-PAK POLYURETHANE SPONGE BAGS: Gold-Sponge-Standard for Environmental Monitoring, material is resistant tears with leading absorbency							
HYDRATED POLYPROBE W/ HICAP™				8" L PROBE	20.3cm L PROBE		
B01592	Round	24 Fl oz.	710 mL	6" W x 9" L	15 x 23 cm	2.5 mils	100
HYDRATED POLYSPONGE W/ HICAP™							
B01590	Round	18 Fl oz.	532 mL	4½" W x 9" L	11.5 x 23 cm	2.5 mils	100
DRY POLYPROBE				8" L PROBE	20.3cm L PROBE		
B01613	Round	24 Fl oz.	710 mL	6" W x 9" L	15 x 23 cm	2.5 mils	100
WHIRL-PAK CELLULOSE SPONGE BAGS: Environmental Monitoring							
HYDRATED SPECI-SPONGE							
B01422	Round	18 Fl oz.	532 mL	4½" W x 9" L	11.5 x 23 cm	2.5 mils	100
B01423 W/GLOVE	Round	18 Fl oz.	532 mL	4½" W x 9" L	11.5 x 23 cm	2.5 mils	100
B01245	Round	18 Fl oz.	532 mL	4½" W x 9" L	11.5 x 23 cm	2.5 mils	100
B01392 W/GLOVE	Round	18 Fl oz.	532 mL	4½" W x 9" L	11.5 x 23 cm	2.5 mils	100
DRY SPECI-SPONGE							
WHIRL-PAK SPONGE ACCESSORIES							
B01593	SpongeProbe Adapter is designed for use with the Whirl-Pak PolyProbe™ or PolySponge™ products listed above.						1
B01559	Replacement Sponge Holder for Sponge Pole (B01457).						1

WHIRL-PAK PRODUCT INDEX

MFG. NO.	PRODUCT	DIMENSIONS		UNITS/BOX
WHIRL-PAK SAMPLE COLLECTION ACCESSORIES				
B01595	Yellow and White Locking Pipe Closures			50
B01040 A	Whirl-Pak Sterilized Spoons			100
WHIRL-PAK SAMPLING STORAGE/TRANSPORT SOLUTIONS				
B00751	12 Compartment Carrying Rack	10"Wx10"Lx3½"H	25.4x25.4x9 cm	1
B01014	20 Compartment Carrying Rack	13¾"Wx10¾"Lx4"H	34 x 27 x 10.2 cm	1
B00772	18 Compartment Carrying Rack	13.1" Wx6.9" Lx3" H	33.3 x 17.5 x 7.6 cm	1
B01048	6 Compartment Carrying Rack	14.25" x 9.75" x 4.25"	36.2 x 24.8 x 10.8 cm	1
B01535	15 Compartment Carrying Rack	9.75" x 6.9" x 3"	24.8 x 17.5 x 7.6 cm	1
WHIRL-PAK SAMPLE COLLECTION TOOLS				
B01310	12 ft. Whirl-Pak Swing Sampler	6' - 12' Extension	1.83 x 3.66 m	1
B01366	24 ft. Whirl-Pak Swing Sampler	24' Extension	7.32 m	1
B01229	Whirl-Pak Sludge Nabber	4' - 6½' Extension	1.22 x 1.99 m	1
WHIRL-PAK SLUDGE JUDGE SERIES				
C09247	Sludge Judge® - 15 ft.	¾"Wx5'LSections	1.9 cm x 1.53 m	1
C09252	Sludge Judge® Top Section w/ Rope	¾"W x 5'L	1.9 cm x 1.53 m	1
C09250	Sludge Judge® Bottom Section w/ Valve	¾"W x 5'L	1.9 cm x 1.53 m	1
C09251	Sludge Judge® Extension Section	¾"W x 5'L	1.9 cm x 1.53 m	1
B01355	Sludge Judge® II - Large Capacity	1½"Wx5'LSections	3.18 cm x 1.53 m	1
B01357	Sludge Judge® II Extension Section	1½"W x 5'L	3.18 cm x 1.53 m	1
B01358	Sludge Judge® II Top Section w/ Rope	1½"W x 5'L	3.18 cm x 1.53 m	1
B01356	Sludge Judge® II Bottom Section w/ Valve	1½"W x 5'L	3.18 cm x 1.53 m	1
B01386	Sludge Judge® Ultra - Super Strong	¾"Wx5'LSections	1.9 cm x 1.53 m	1
B01388	Sludge Judge® Ultra Extension Section	¾"W x 5'L	1.9 cm x 1.53 m	1
B01387	Sludge Judge® Ultra Top Section w/ Rope	¾"W x 5'L	1.9 cm x 1.53 m	1
B01389	Sludge Judge® Ultra Bottom Section w/ Valve	¾"W x 5'L	1.9 cm x 1.53 m	1
WHIRL-PAK COLLECTION TOOL ACCESSORIES				
B01291	6 ft. Cleaning Brush for use with Sludge Judge Collection Tools	1"W x 6'L	2.54 cm x 1.83 m	1
B01361	Replacement Bottle Holder for Whirl-Pak Swing Samplers			1
C09249	Case for Sludge Judge Collection Tools			1
B01354	Cleaning Brush for use with Sludge Judge II			1



CONTACT AN APPROVED
WHIRL-PAK DISTRIBUTOR
FOR PRICING

ABOUT OUR COMPANY

MAKING THE WORLD SAFER, HEALTHIER, AND MORE PRODUCTIVE

It all began with milk. In the early 1950s, milk was transported in bulk tanks after being collected from dairy farms along a specific route. With each farm's product becoming combined in one blend, farmers soon began to voice concerns over the potential risk for a reduction in overall milk quality. Taking up the issue in 1954, Harold Barnum, a leading authority in the milk sanitation industry, developed a process called the "Universal Sampling Procedure." With this method, a milk truck driver could collect milk samples from each farm and test it prior to transport in order to ensure its quality throughout the process. Because of the effectiveness of this testing, Barnum soon saw a need for mass production of leak-proof closure bags, and Whirl-Pak was officially established in 1959. Because Barnum transformed the dairy industry, he began to explore quality assurance testing and sampling in other industries, such as food, beverage, and water. Today we live in a safer, healthier world thanks to Barnum's vision, and our business continues to thrive because of his tireless work.

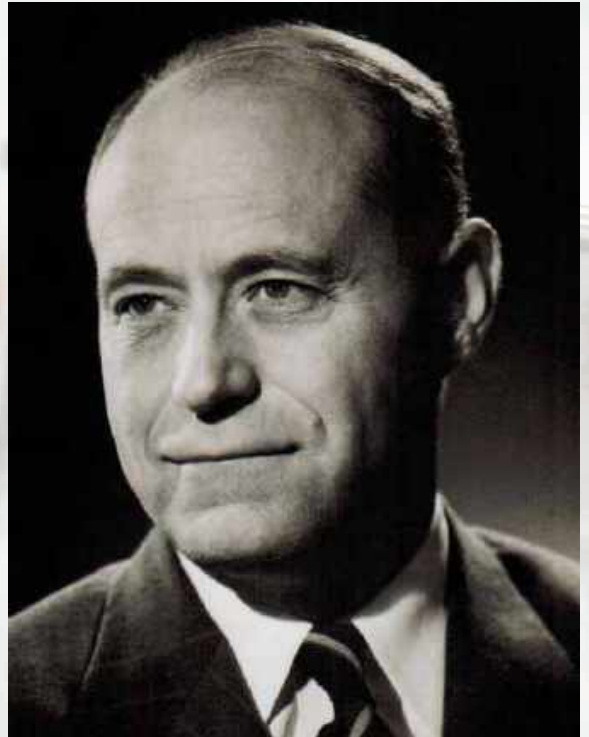

keeping liquid samples safe
SINCE 1959

At Whirl-Pak, Filtration Group we continue to strive for excellence with secure sampling bags that ensure the safety of consumers while improving efficiencies in processing facilities and laboratories. As quality management policies and regulation requirements change, the health and safety of the consumer depends on the accuracy of your test results. Whirl-Pak can help you deliver the best possible outcome each and every time.

As a part of Filtration Group, we will continue to deliver solutions that best fit the needs of our customers and improve their processes. It is our mission to make the world safer, healthier, and more productive.



WHIRL-PAK®

Filtration Group

9501 80th Ave.

Pleasant Prairie, WI. 53158



Sampling Solutions that Meet YOUR
Standards for Results You Trust

Start your trial today!

To learn more, or to view our entire product portfolio visit www.WHIRL-PAK.COM
